

THESE DRAWINGS AND RELATED PROPERTY OF WISCONSIN LUMBER BUILDING SUPPLIES CENTER. THESE DRAWINGS ARE THE PROPERTY OF WISCONSIN LUMBER BUILDING SUPPLIES CENTER AND ARE NOT TO BE REPRODUCED, COPIED, OR TRANSMITTED IN ANY FORM OR BY ANY MEANS, ELECTRONIC OR MECHANICAL, INCLUDING PHOTOCOPYING, RECORDING, OR BY ANY INFORMATION STORAGE AND RETRIEVAL SYSTEM, WITHOUT THE WRITTEN PERMISSION OF WISCONSIN LUMBER BUILDING SUPPLIES CENTER. THE CONTRACTOR IS RESPONSIBLE TO VERIFY ALL DIMENSIONS AND MATERIALS AND CONDITIONS TO BE SHOWN IN THESE DRAWINGS DO NOT SCALE DRAWINGS.

LEGEND

- ⊙ DENOTES SMOKE-CARBON MONOXIDE COMBINATION DETECTOR UNIT
 - Ⓢ DENOTES SMOKE DETECTOR UNIT
- NOTE: ALL DETECTOR UNITS MUST BE HARD-WIRED ELECTRICAL UNITS WITH INTERCONNECTED ALARMS

GENERAL NOTES:

1. ALL INTERIOR LINTELS WITH LOAD BEARING ABOVE SHALL BE 2x10 SFR #2 OR BETTER, UNLESS NOTED OTHERWISE ON PLAN.
2. ALL EXTERIOR LINTELS TO MAX GSPAN OF 2'-0" THIS FLOOR SHALL BE 2x10 SFR #2 OR BETTER, UNLESS NOTED OTHERWISE ON PLAN.
3. PROVIDE SOLID BLOCKING WITHIN JOIST SPACE UNDER ALL CONCENTRATED LOAD LOCATIONS
4. ALL ELECTRICAL WORK SHALL BE COMPLETED AS PER OBC SECTION 9.34. (ELECTRICAL FACILITIES)
5. WHERE BEAMS ARE INDICATED TO BE FLUSH THEY ARE TO BE INSTALLED FLUSH TO THE UNDERSIDE OF THE FLOOR FRAMING IN SYSTEM WHERE POSITION TOP OF FLUSH BEAM TO 1/5" OF SUBFLOOR
6. CEILING FINISH IN LOWER BATHHOUSE LEVEL SHALL BE INSTALLED PER FITTING AND COMPLETE PRIOR TO BURBLING WATER FOR ICE REMOVAL MEASURES, OR MEASURES MUST BE TAKEN TO ENSURE ENGINEERED WOOD SYSTEMS REMAIN FREE OF CONDENSATION

AREA ANALYSIS

COVERED AREA: 1880 S.F.
BOATHOUSE ARCH: 1880 S.F.

No.	Revised For	Date	Drawn
2	ISSUED FOR BILLING PERMIT	DEC. 20/17	T.K.K./L.V.L.
1	FOR PROWING	NOV. 27/17	

Revisions:

PROJECT
New BOATHOUSE for Devin DeGroote
1011 Marquis Lane
DOCK LEVEL FLOOR PLAN

Author	Drawn
Diagono, Devin/Margis	T.K.K./L.V.L.
File	Date
Diagono\boathouse.dwg	October 2017
Job No.	Scale
17736	1/4"=1'-0"
Sheet No.	

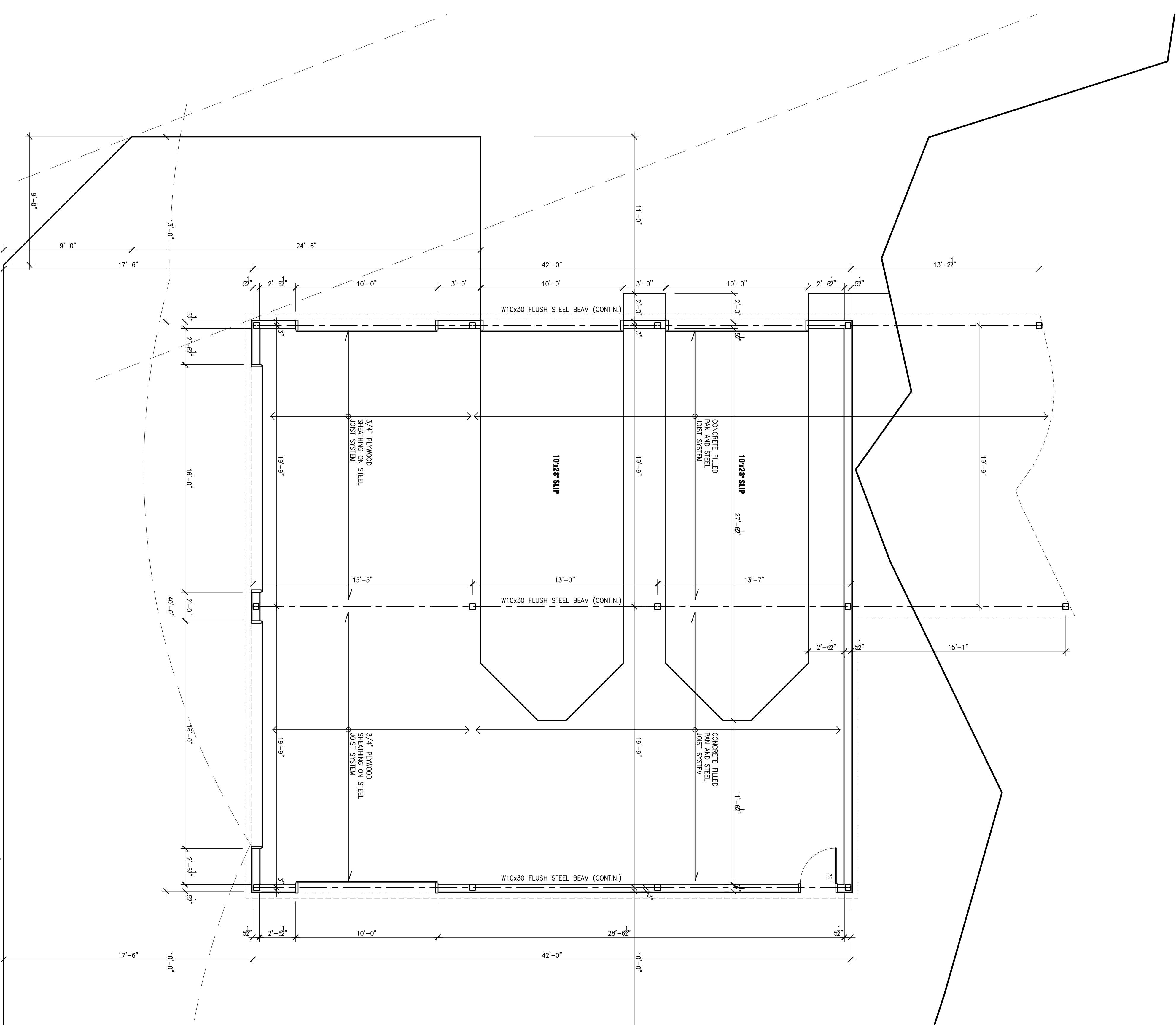

CONSTRUCTION SCHEDULE

EXTERIOR WALL ASSEMBLY:
 -1x6 WOOD BEVEL SINKING ON
 -1/2" GROUT
 -1/2" PLYWOOD SHEATHING ON
 -2x6 STUDS AT 16" O.C.
FLOOR ASSEMBLY w/ STONE FINISH:
 -GRANITE STONE PAVERS ON
 -1" MORTAR BED ON
 -1/2" GROUT
 -MIN. 4" THICK CONC. SLAB SLOPED
 TO EDGES ON
 -TOTAL JOIST ENG. METAL FLOOR
 SYSTEM ON
 -1x6 TAG CEILING FINISH

FLOOR ASSEMBLY w/ WOOD FINISH:
 -5/4" PLYWOOD ON
 -2x TAPERED SLEEPERS ON
 -WATER-PROOF MEMBRANE ON
 -3/4" PLYWOOD SUBFLOOR ON
 -2x6 BEAMS ON
 -TOTAL JOIST ENG. METAL FLOOR
 SYSTEM ON
 -1x6 TAG CEILING FINISH

DOCK LEVEL FLOOR PLAN